

Air flow sensors without amplifier for explosive areas | STS 215 S

- ATEX screw-in sensors for air flow monitoring
- Design with one measuring pins
- Designs in device category 1 or 1/2
- Use in dust- or gas-explosive areas
- Flow monitoring for fans
- Flow monitoring in exhaust air ducts in Ex areas



G1/2 - sensor length 48 mm - Ex-Zone 0/20 - M12 connector

| | |
|---|--|
| TYPE | STS 215 S |
| Product ID | P11207 |
| Medium | air |
| Detection range air | 2 ... 25 m/s |
| Process connection | G1/2 |
| Sensor length L | 48 mm |
| Output | output with separate Amplifier |
| Ex area of use | installation in partition wall Zone 0/1, Zone 0, Zone 20 |
| ATEX Certificate | TÜV 98 ATEX 1298 X |
| Marking gas Ex for partition wall mounting | Ex II 1/2 G Ex ia IIC T6...T3 Ga/Gb |
| ATEX marking gas | Ex II 1 G Ex ia IIC T6...T3 Ga |
| ATEX Marking dust | Ex II 1 D Ex ia IIIC T130°C Da |
| Maximum values | U _i = 13.65 V / I _i = 200 mA / P _i = 0.69 W / C _i = 0.45 nF / L _i = 1.80 µH |
| Temperature range in T6 | -20 ... 35 °C |
| Temperature range in T5 | -20 ... 50 °C |
| Temperature range in T4 | -20 ... 85 °C |
| Temperature range in T3 | -20 ... 85 °C |
| Temperature range dust-Ex | -20 ... 85 °C |
| Start-up time typ. | 5 ... 20 s |
| Reaction time typ. | 3 s (2 ... 30 s) |

| | |
|---|--|
| Compressive strength | 10 bar |
| Material sensor touched by medium | stainless steel AISI 316 Ti |
| Material housing | stainless steel AISI 316 Ti, brass, PA |
| Protection [EN 60529] | IP 67 |
| Electrical connection | M12 connector |
| Accessories (in scope of delivery) | 2 x gasket G1/2 AFM 34 |
| Associated amplifiers | SZAb 400 EX-GR, SZAb 400 EX-WR115, SZAb 400 EX-WR230, SZAb 400 EX-GA |

Technical Image

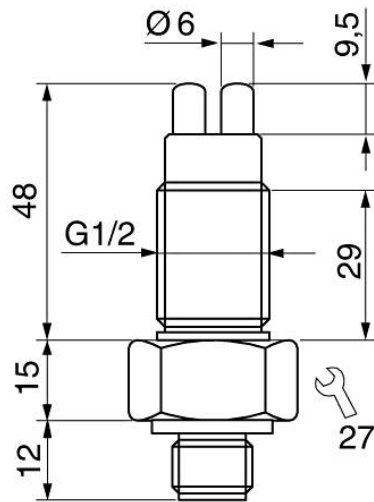

Pin Map

