

# Sensors for use at high temperatures |

## INT020-S200 K

- High temperature up to 200° C
- With PTFE sleeve
- To connect to an external analysis device series INT
- For use at temperatures up to 200° C
- Resistant to aggressive media
- Switching distance up to 50 mm
- For use at high temperatures
- For use in aggressive environments



### Ø36 mm - sn 15 mm non flush

<b>TYPE</b>	INT020-S200 K
<b>Product ID</b>	P31101
<b>Operating Distance sn</b>	15 mm non-flush
<b>Adjustment range</b>	5 ... 20 mm
<b>Ambient temperature</b>	0 ... 200 °C
<b>Limit temperature</b>	250 °C
<b>Temperature deviation</b>	5 %
<b>EMC-class</b>	B
<b>Material housing</b>	PTFE
<b>Material cap</b>	PTFE
<b>Protection [EN 60529]</b>	IP 40
<b>Associated amplifiers</b>	IKM 120 GPP
<b>Temperature deviation</b>	nicht linear

Technical Image

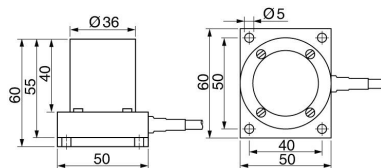

Pin Map

