

Sensors with integrated amplifier | SN 450 GPP

- Screw-in sensor for flow monitoring
- Robust, compact design
- With switching or analogue output
- Flow monitoring in rough and corrosive environments with heightened requirements for the stability and durability of a device



G 1/2 - sensor length 31 mm - 24 VDC - 2x PNP NO

TYPE	SN 450 GPP
Product ID	P11264
Medium	Water, oil
Detection range water	1 ... 150 cm/s
Detection range Oil	3 ... 300 cm/s
Process connection	G1/2
Sensor length L	31 mm
Output	switching output
Output function	PNP-NO
Supply voltage	24 VDC +/- 20 %
Current consumption max.	100 mA
Switching current max.	200 mA (20 °C) each output
Reverse polarity protection	✓
Voltage drop max.	2.5 V
Ambient temperature	-20 ... 60 °C
Medium temperature	-20 ... 80 °C
Temperature gradient fluids	250 K/min
Start-up time typ.	8 s (2 ... 15 s)
Reaction time typ.	2 s (1 ... 13 s)
Compressive strength	100 bar

Material sensor touched by medium	stainless steel AISI 316 Ti
Material housing	PBT
Display flow	LED-Array
Protection [EN 60529]	IP 67
Electrical connection	M12 connector

Accessories (in scope of delivery)
 2 x gasket G1/2 AFM 34, screwdriver

Technical Image

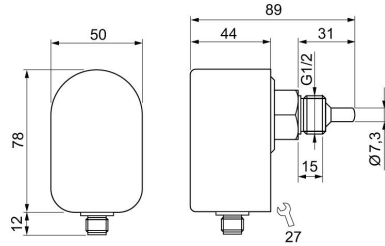

Pin Map

